

# ZenVoice

Alexa! Send my regards to Zennio  
for making my life easier!



# ZenVoice

What do I need to begin?

- Z70 v2 with the following items:
  - ✓ Remote control license.
  - ✓ Application program 3.4. Parameter for voice control enabled.



# ZenVoice

## 1. Create a ZRC account

- Now you will have to update Zennio Remote app to the **latest version available 1.2.0**:



- Once you have downloaded and installed the latest version, create an user:

Your user for Zennio Remote Control (ZRC) will be:

ZRC user:

- E-mail : example@hotmail.com
- Password: Zennio123



Zennio Remote



# ZenVoice

## 2. Downloading Amazon Alexa

- Download Amazon Alexa.
- If you already have a registered account for Amazon, simply log-in with it in Alexa app. In case you do not have an Amazon account, you will need to [create one](#).

- Amazon account:



- E-mail: cuenta@gmail.com
- Password: AmazonPW



These credentials refers to the ones from your Amazon account, used to access this platform.  
It is not required for the e-mail registered for ZRC and your Amazon account to match.



# ZenVoice

## 3. Download ZenVoice skill for Alexa (part 1)

1. Search for the skill "ZenVoice" on Amazon Alexa Skill menu and download it.

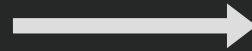

2. After downloading the skill, log-in with your ZRC account in order to link Amazon and ZRC accounts together.

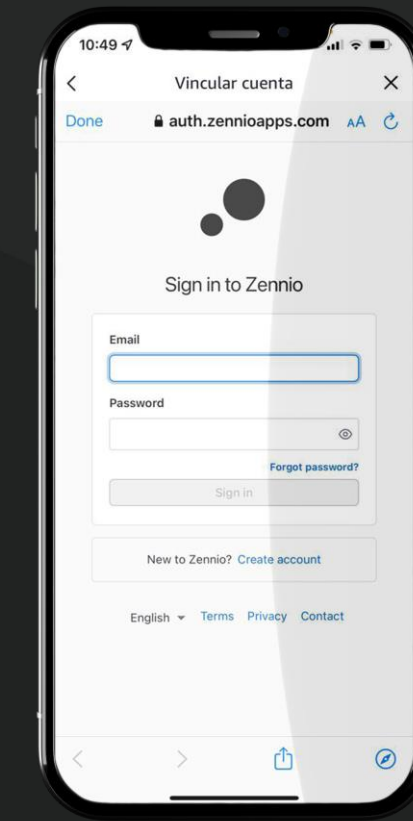

ZRC User:

- E-mail : ejemplo@hotmail.com
- Password: Zennio123

This step will link your ZRC account to your Amazon account. You will receive a notification via e-mail once both accounts are linked.

# ZenVoice

## 3. Download ZenVoice skill for Alexa (part 2)

HELP! I cannot find Alexa in Amazon's Marketplace.

- Amazon Alexa app is available for the following languages:

German (DE)  
Spanish (SP)  
French (FR)  
English (EN)  
Italian (IT)

- If you are unable to find Alexa app in your Marketplace, you will need to modify your country/region of your Amazon account:

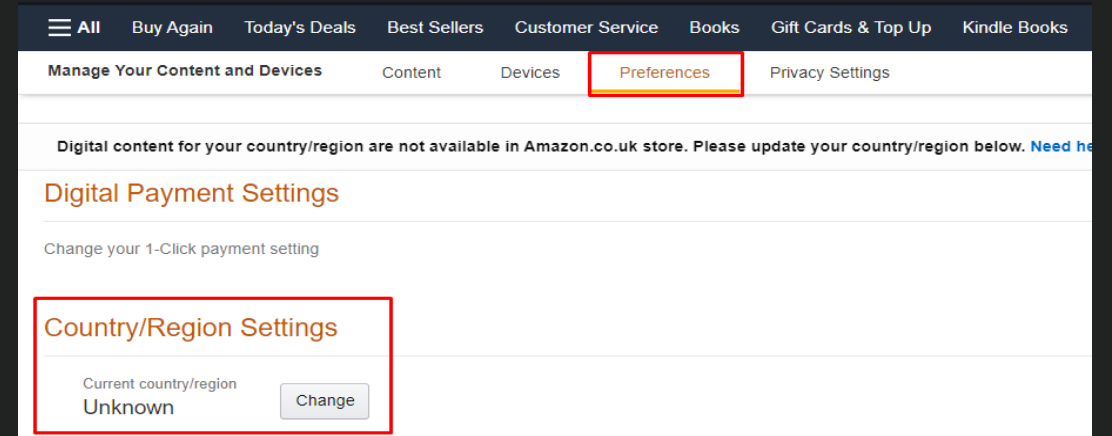
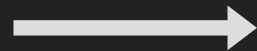
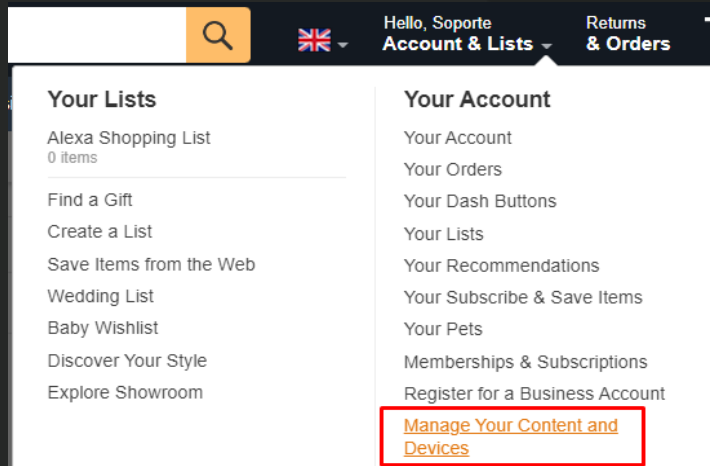

# ZenVoice

## 4. Set up ZenVoice

Your ZRC and Amazon accounts are now linked and ready!

- Access ZenVoice web configurator through the link:

<https://zenvoice.zennioapps.com/>

- Your user to log-in will be the registered one for ZRC:

ZRC User:

- Email : ejemplo@hotmail.com
- Password: Zennio123

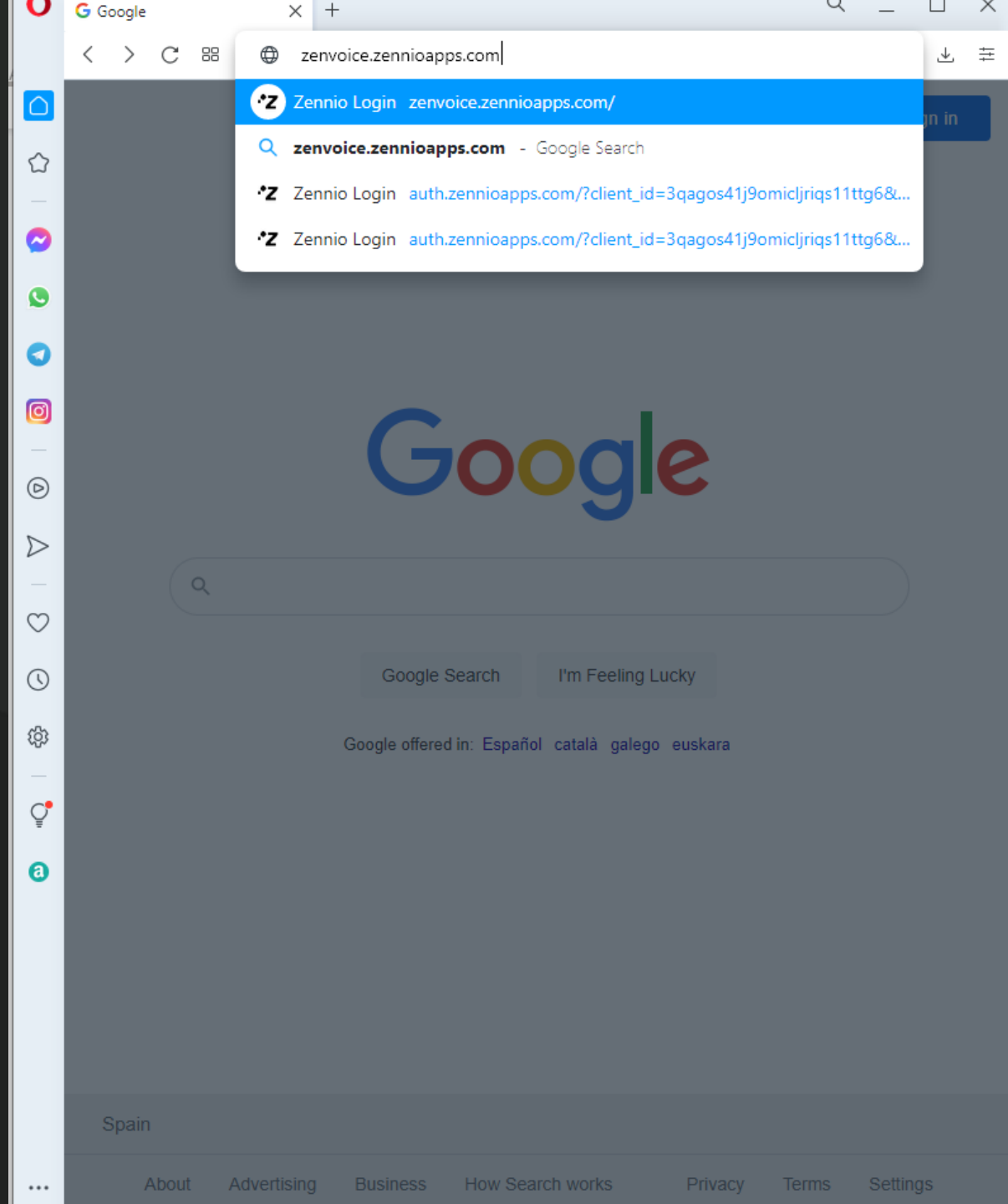

# ZenVoice

## 5. Configure voice controls

- By accessing your ZenVoice's setup via web, a list containing all Z70 v2 linked to your ZRC account will be displayed.
- It will be possible to configure those that fulfill these conditions:
  1. ZenVoice or demo license active.
  2. Application program 3.4 with voice control parameter enabled.

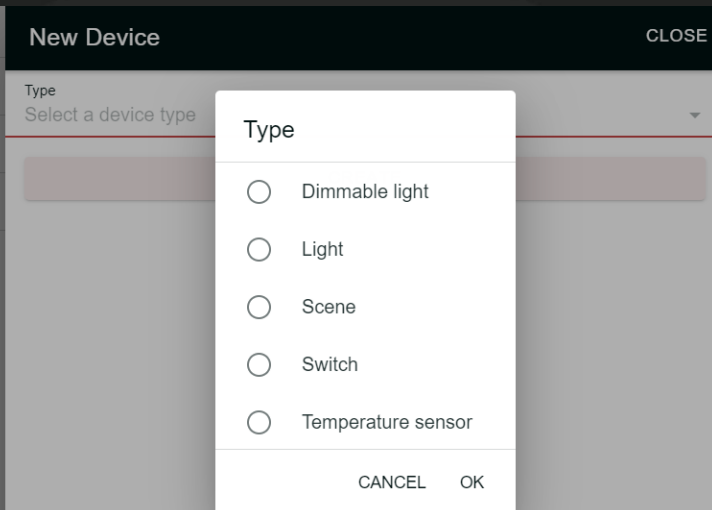
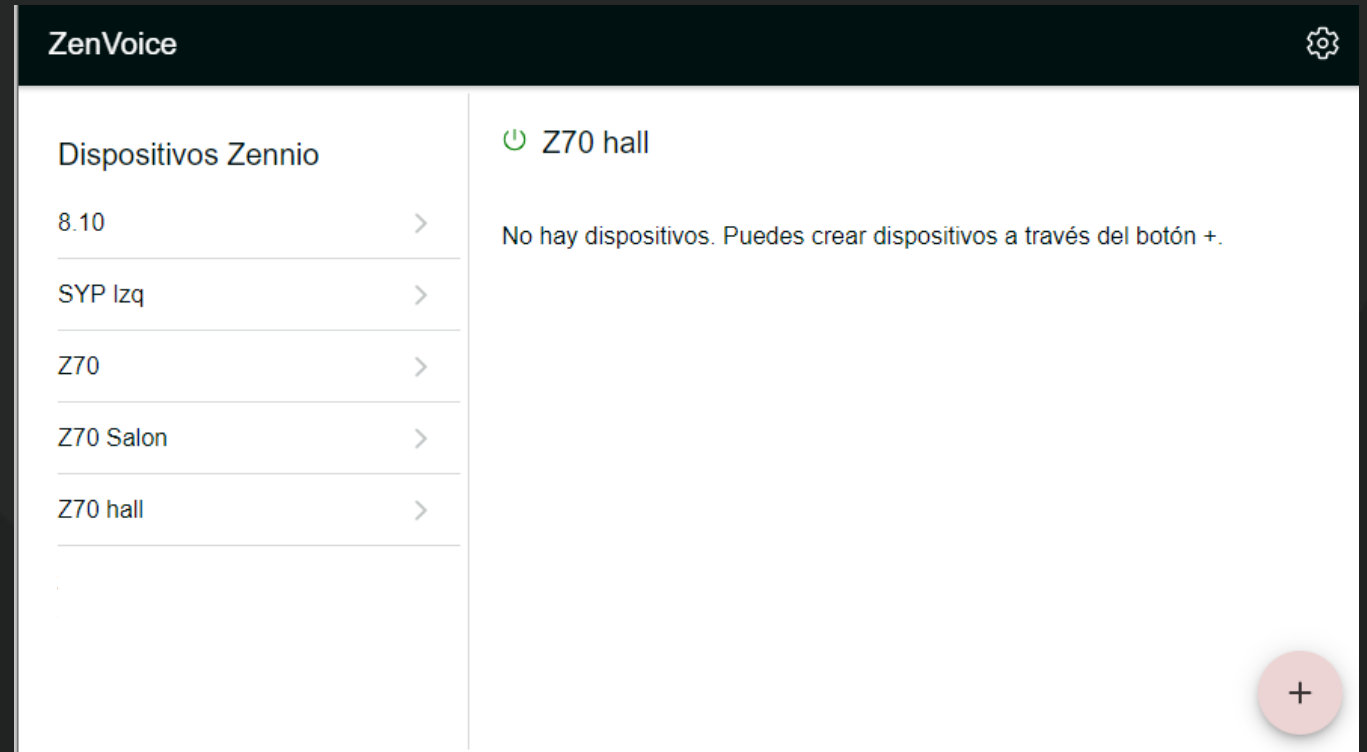

- When a type of control has been selected, ZenVoice will perform a quick search of the compatible controls, excluding those that do not match the criteria.
- For instance, switch and lighting On/Off controls would be equivalent, varying only the icons that represent each kind of control. Also, the voice controls for Alexa will require different key words:

*Alexa, turn off all lights!* → Lighting On/Off controls will be turned off, but not switch controls.



# ZenVoice

## 6. Communicate with Alexa

- There are two options in order to transmit voice commands with Alexa:
  1. Using the APP Amazon Alexa.
  2. Using an ECHO speaker or similar device.

Z70 v2 IS NOT a smart speaker, it will only work as a gateway, so you MUST NOT voice the commands to Z70 v2.

- Alexa, turn on the lights.
- OK!



ZenVoice

# ZenVoice

## 7. Compatibles controls and voice commands

- **Switch & On/Off control**
  - Alexa! Turn on lamp light.
  - Alexa! Turn on ceiling fan.
  - Alexa! Turn off AC.
- **Temperature sensor control**
  - Alexa! What is the temperature of the Office?
  - ¡Alexa! What is the temperature of Bedroom?
- **Dimmer control**
  - Alexa! Ceiling light brightness 50%.
  - Alexa! Turn on ceiling light.
- **Scene control**
  - Alexa! Turn on "scene control name".
  - Alexa! Turn on exit.
  - Alexa! Turn on cinema.
- **Thermostat control**
  - Alexa! Set thermostat to 23 degrees.
  - Alexa! Lower living room temperatura 2 degrees.
- **Shutter control**
  - Alexa! Raise/lower the blind.
  - Alexa! Set blind to 60%.
- **RGB light control**
  - Alexa! Turn on RGB light.
  - Alexa! Set.

### IMPORTANT!

For dimmer controls to work, it is mandatory to link precise dimming (1 byte) since Alexa does not allow the use of relative dimming (4-bit).



• ***Zennio***